

## Directions:

# *snapshot*<sup>™</sup> with BioControl Lightning

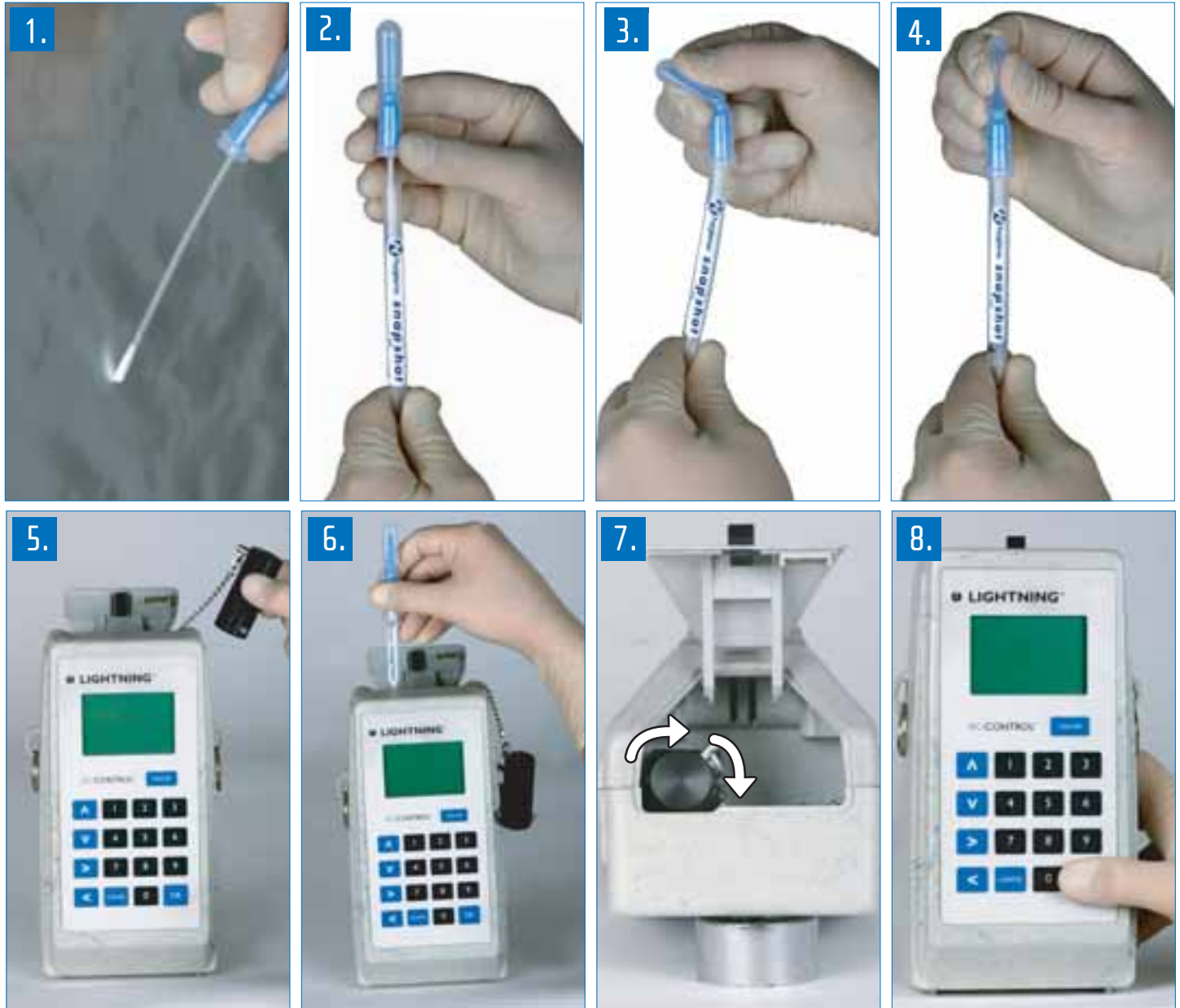

1. Swab sample point.
2. Place swab back in swab tube.
3. Holding the swab tube firmly, use the thumb and forefinger to break the Snap Valve<sup>™</sup> by bending the bulb forward and backwards.
4. Squeeze the bulb twice, expelling all liquid down the swab shaft.
5. Remove old black cap and replace with new cap (#BCCAP).
6. Insert *snapshot* into reading slot.
7. Press cap down and turn 90°.
8. Take reading as normal.